



PRODUCT NUMBER: Casing pipe type FL/ZE | stainless steel V2A

KRASO® Casing pipe type FL/ZE | stainless steel V2A

Area of application

Fixed/loose flange for encasing in concrete, with sleeve, for accommodating media pipes using KRASO® sealing insert (not included in delivery), for buildings with external sealing ("black tank") against pressurized / non-pressurized water according to DIN 18533. Available in stainless steel V2A or galvanized with plastic sleeve, each with or without special coating.

I DIN 18533 W1-E and W2.1-E (version "non-pressing water"), W2.2-E (version "pressing water")

Product image



Technical drawing

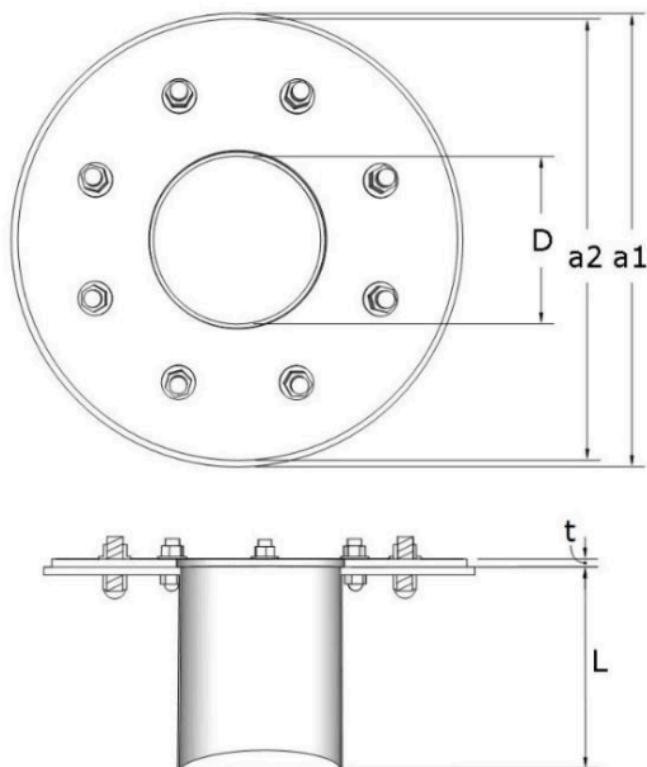

•D | Casing inner diameter (mm) •a1 | Fixed flange outer diameter (mm) •a2 | Loose flange outer diameter (mm) •L | Casing length (cm)
•t | Plate thickness (mm) •Weight | in kg (exact details on request)

The information contained in this technical data sheet is based on the results of our research and our practical experience in this field. All test data are average values obtained under the specified conditions. The correct and therefore effective and successful installation of our products is beyond our control. The installer is responsible for the correct installation and the final results of the construction process, taking into account the specific conditions of the site. This may require adaptation of the recommendations given in this document for standard cases. Specifications given by our employees or representatives that exceed the specifications contained in this technical guideline require written confirmation. The standards, technical guidelines and generally accepted technological requirements applicable to testing and installation must be adhered to. We can therefore only guarantee and warrant the quality of our products under the conditions we specify, not their effective and successful installation. This guideline has been technically revised and all previous versions are invalid.



material

Flange plate / Feed ear	stainless steel V2A
allowances	EPDM flat gasket 3mm 50 +/- 5 Shore
Fastening material	Bolts, nuts and washers M20 or M12

Technical details

- For buildings with external waterproofing ("black tank"): according to DIN 18533 ("Waterproofing of building components in contact with the ground")
- Available in stainless steel V2A or V4A and in galvanized steel
- Available in versions for pressurised (DIN 18533 W2-E) and non-pressurised water (DIN 18533 W1-E).

Test certificates

[Find in our download area](#)

KRASO® Casing pipe type FL/ZE I stainless steel V2A

Type / Item	KRASO® casing pipe type FL/ZE - PRESSURE WATER according to DIN 18533 W2-E						
D I	80	100	125	150	200	250	300
a1I	400	420	445	470	520	570	620
a2 I	380	400	425	450	500	550	600
L I	20 • 24 • 25 • 30 • 35 • 36.5 • 40 • 45 • 50						
T I	10	10	10	10	10	10	10
Weight I	22.7 – 23.6	23.6 – 26.8	27.5 – 29.4	29.8 – 32	35.1 – 38.2	40.9 – 45.9	46.7 – 53.5
Article No. I	KFLDDZE080	KFLDDZE100	KFLDDZE125	KFLDDZE150	KFLDDZE200	KFLDDZE250	KFLDDZE300

Type / Item	KRASO® casing pipe type FL/ZE – NON- PRESSURIZING WATER according to DIN 18533 W1-E						
D I	80	100	125	150	200	250	300
a1I	220	240	265	290	340	390	440
a2I	200	220	245	270	320	370	420
L I	20 • 24 • 25 • 30 • 35 • 36.5 • 40 • 45 • 50						
T I	6	6	6	6	6	6	6
WeightI	8.6 – 9.5	10.2 – 11.7	11.3 – 13.3	12.5 – 14.8	15.7 – 18.7	19.2 – 24.2	22.8 – 29.6
Article No. I	KFLEDZE080	KFLEDZE100	KFLEDZE125	KFLEDZE150	KFLEDZE200	KFLEDZE250	KFLEDZE300

•D I Casing inner diameter (mm) •a1 I Outer diameter of fixed flange (approx. mm) •a2 I Outer diameter of loose flange (approx. mm) •L I Length of casing (cm) •T I Plate thickness (mm) •Weight I in kg (exact details on request)

The information contained in this technical data sheet is based on the results of our research and our practical experience in this field. All test data are average values obtained under the specified conditions. The correct and therefore effective and successful installation of our products is beyond our control. The installer is responsible for the correct installation and the final results of the construction process, taking into account the specific conditions of the site. This may require adaptation of the recommendations given in this document for standard cases. Specifications given by our employees or representatives that exceed the specifications contained in this technical guideline require written confirmation. The standards, technical guidelines and generally accepted technological requirements applicable to testing and installation must be adhered to. We can therefore only guarantee and warrant the quality of our products under the conditions we specify, not their effective and successful installation. This guideline has been technically revised and all previous versions are invalid.